

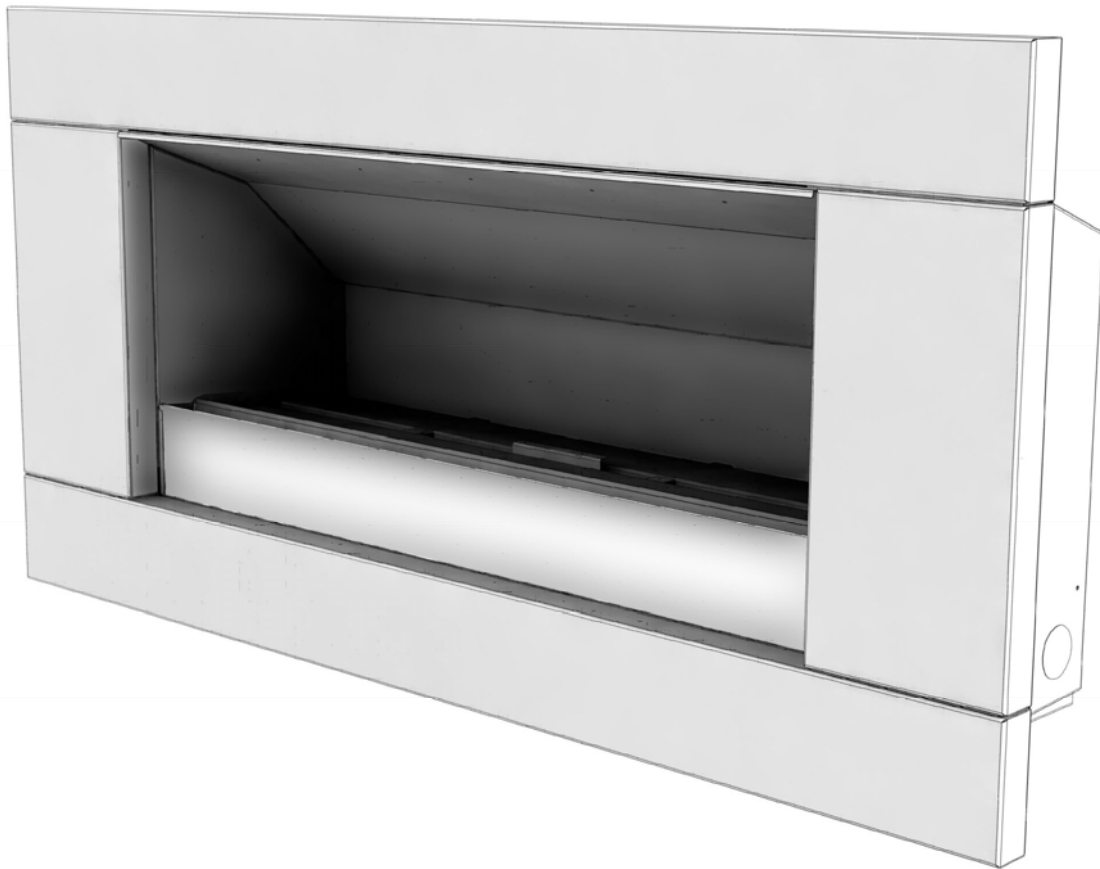

Gas Type Conversion

EF5000 – Australia



- **Installation, service and gas conversion must be performed by a qualified installer, service agency or gas supplier.**
- **WARNING: Improper installation, adjustment, alteration, service or maintenance can cause injury or property damage. Read the installation, operating and maintenance instructions thoroughly before installing or servicing this equipment.**

Manufactured by: Escea Ltd, PO Box 5277 Dunedin NZ, Ph: +64 3 479 0302, email: info@escea.com.au
For contact details of your local Escea distributor or dealer please visit www.escea.com.au

630074_3 Gas Conversion Instructions EF5000 AUS.doc

Warning: Before starting the gas conversion, ensure that the fireplace is cool.

Step One:

Lift the fascia and hang it in the second slot, now you can unplug the fascia lead and remove the Fascia from the EF5000 firebox by lifting up and outwards. This will give you access to remove the Burners and Stone tray.

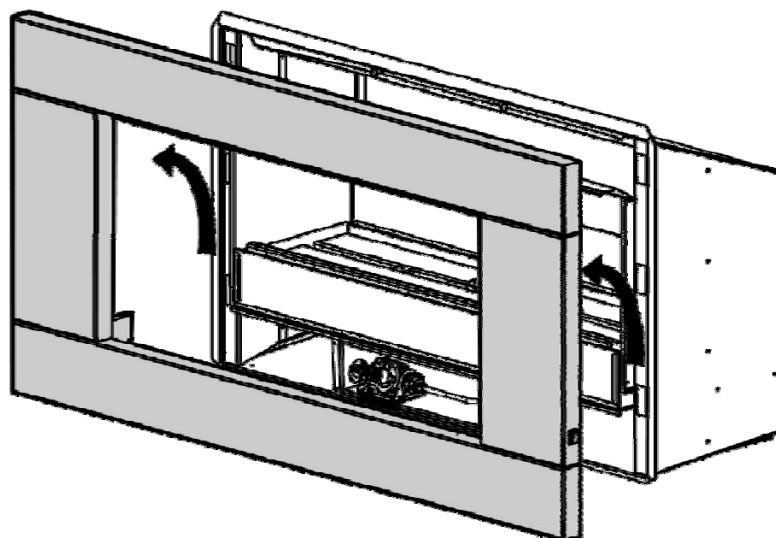

Step Two:

Remove all of the coals and the two screws holding the burner clamps in place, remove the clamps.

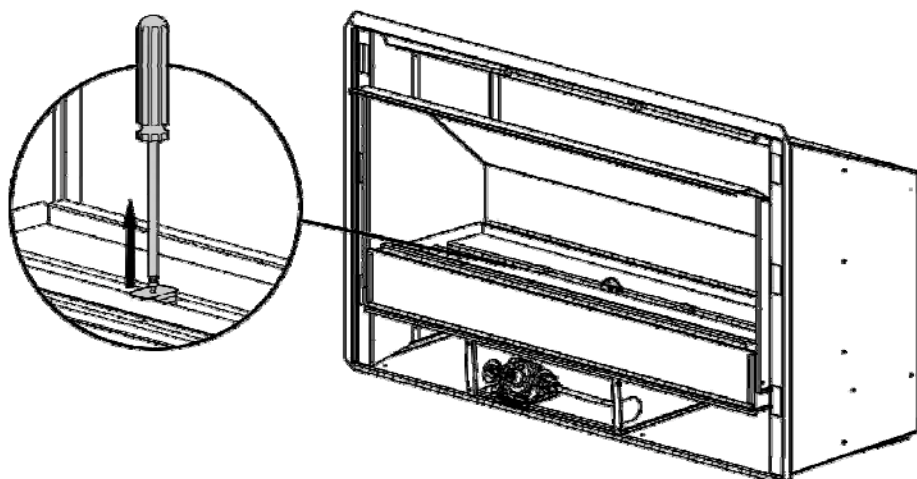

Step Three:

Remove the two screws holding the Stone tray in place and lift it out.

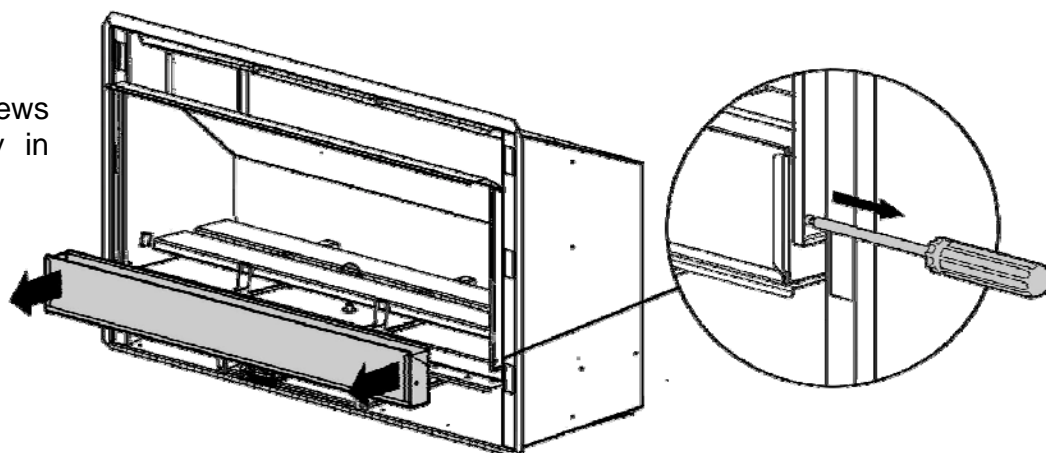

Step Four:

Lift out both burners, this will give you access to the jets (spuds).

Step Five:

Change the two jets with the conversion jets supplied in kitset. Cover the existing gas type label with the new gas type label supplied in kitset. Ensure serial number and date of manufacture are still visible. Write your name, company (if appropriate) and date of conversion on new label with permanent marker.

Step Six:

Replace the pilot jet with the one supplied in the kit.

Note: You will have to remove the cover from behind the pilot assembly, it may be helpful to remove the control tray completely for best access.

Step Seven:

Take the regulator spring out of the regulator by unscrewing the pressure adjustment knob completely. Swap regulator spring with the new spring that is supplied in conversion kitset. Replace adjustment screw and reset gas pressure as per instructions below or in the service manual.

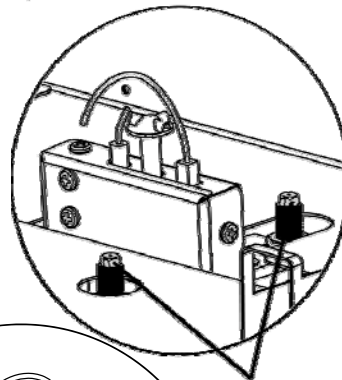
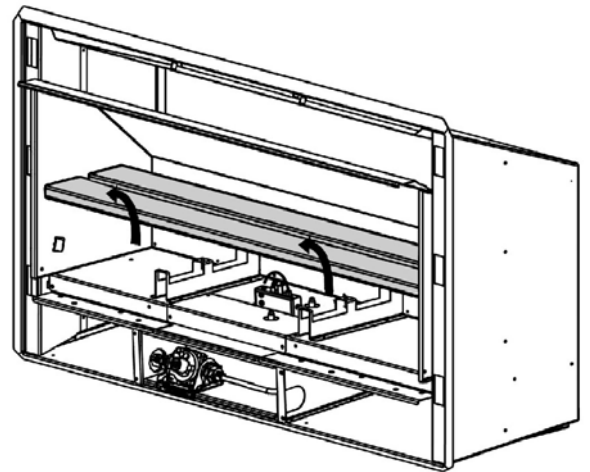

Burner Jets

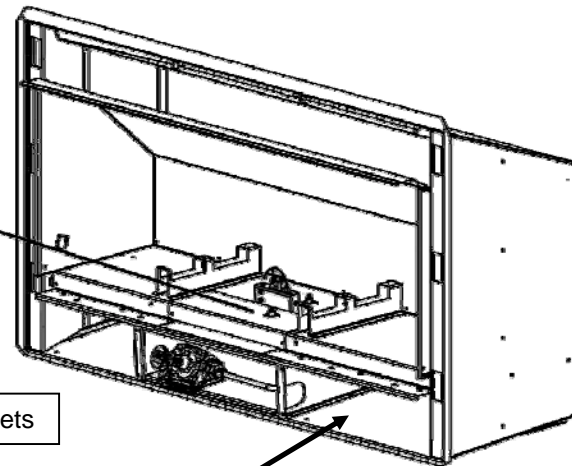

Data Label Position

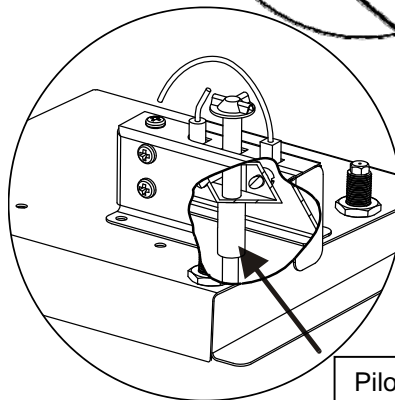

Pilot Jet

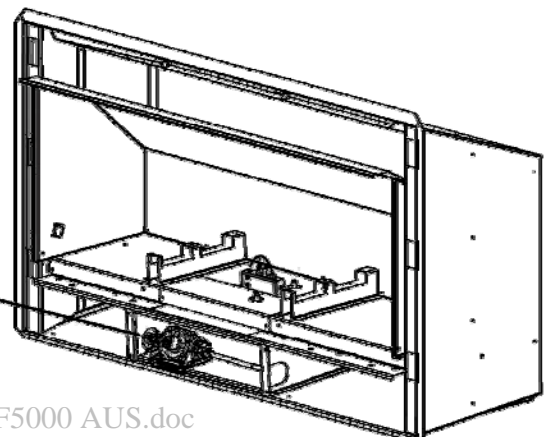
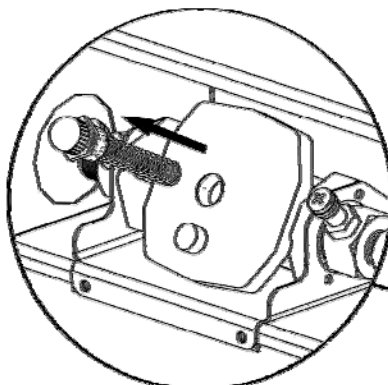
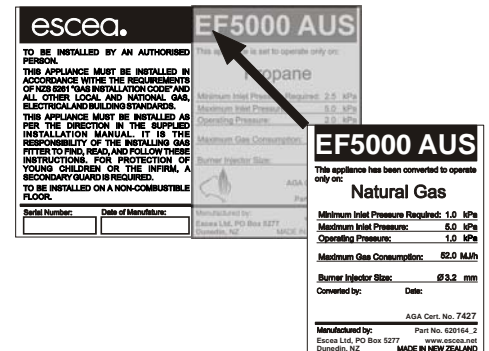

	Natural Gas	Propane
kPa	1.0	2.0

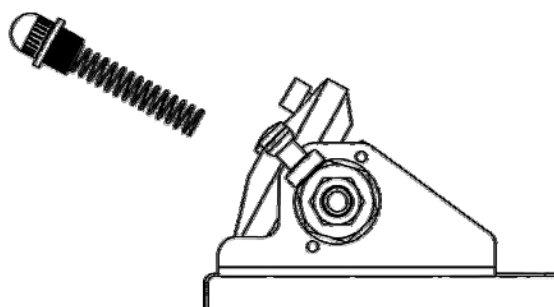

Note: If you have been supplied with a **new pair of conversion burners**, skip step eight and continue with **step nine**.

If you have been supplied with **only the restrictor sleeves** then continue with **step eight**.

Step Eight:

For Propane to Natural gas conversion you will need to fit the natural gas restrictor sleeve. These slide over the burner tube on the underside of the burners, and must be screwed into place so that the porting holes line up.

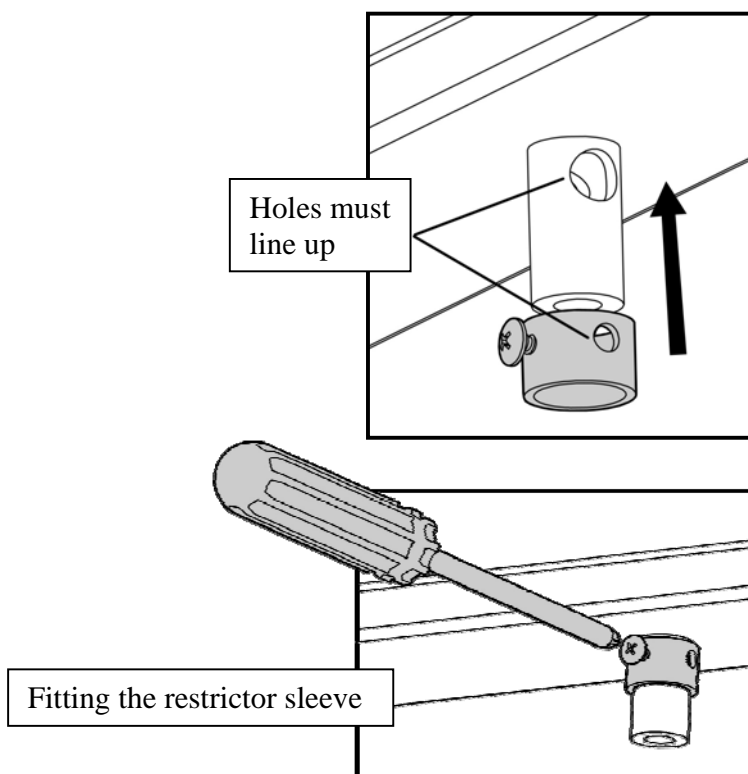

Note: For Natural gas to Propane conversion remove the restrictor sleeves from the burners.

Step Nine:

- a) Insert the new or modified burners and fix them into place with the burner clamps.
- b) Replace the stone tray and fix it back onto the firebox.
- c) Replace the coals, ensuring you have only one even layer.
Do not heap or mound the coals.

Step Ten:

Re-attach the fascia power supply lead. Push them together until they 'click'. Line up the hooks with the receptacles on the Firebox, take advantage of the first slot in the hook where you can rest the fascia before you push the fascia into position.

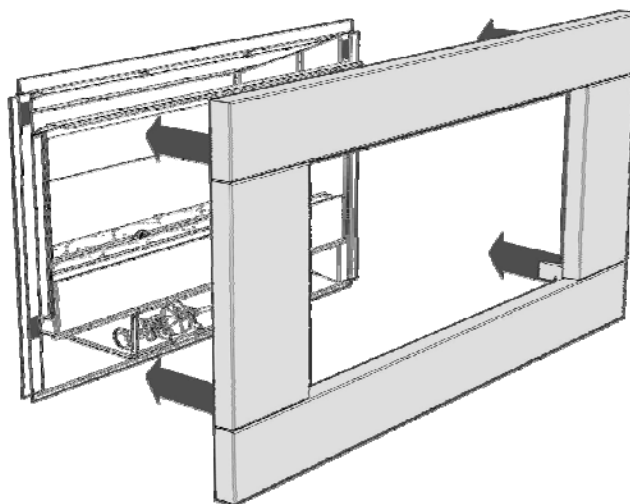
**Step Eleven:**

When you have pushed the fascia in as far as it will go, briefly push down on the fascia to secure the fascia into position.

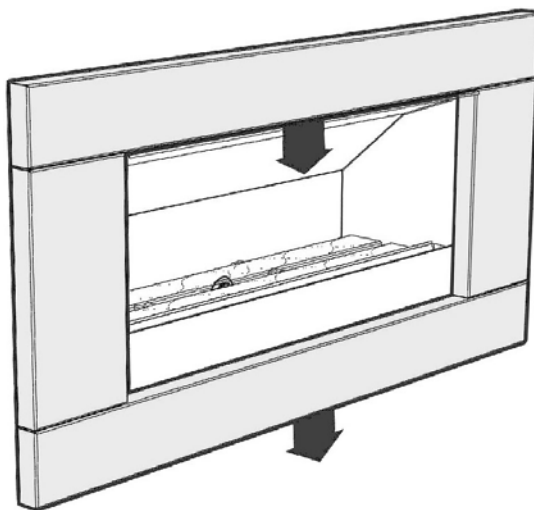

Once the fire has been re-assembled, test the fire to ensure it is running correctly.