

# FERNBANK

Preceding model F7000



The Fernbank offers an ultra stylish alternative look for the modern day home. With its huge heating capacity, it's perfect for warming large areas and it's panoramic glass door allows for optimum view of your log fire.

- Heats large sized areas
- Superior heat from a fully finned cast iron firebox and triple air combustion system
- Standard 2-speed fan for faster heat circulation
- Fitted with masonry brick and steel baffle
- Smooth release door latch with adjustable door hinge
- Included wet back option

MODEL	993908
FINISH	VHT Black
FIREBOX	Cast Iron
EST. PEAK OUTPUT	24kW
APPROX. HEAT AREA	240m <sup>2</sup>
EMISSIONS	1.1g/kg
EFFICIENCY	58%
CIRCULATION	2-speed convection fan
DIMENSIONS (WxDxH)	685 x 583 x 835mm
FIREBOX DIMENSIONS (WxDxH)	495 x 436 x 345mm
LOG SIZE	450mm

Minimum distance to heat sensitive materials (mm) when a flue deflector is fitted, and floor protector sizes as per standard AS/NZS 2918:2001.

FLUE SHIELD	A	B	C	D	E	F	G	H
FUF	225	400	300	139	125	445	743	442
	I	J	K	L	M	N	R	W
	663	963	1089	1269	1132	644	625	685

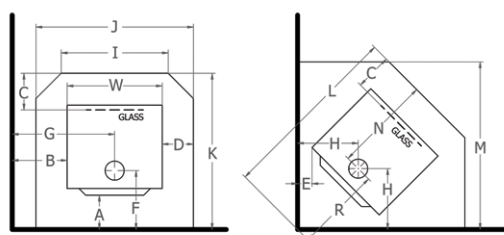

FUF: Flomet Universal Flue system with full length decorative heat shield.

