

REDBANK

Preceding model R1600



INTEGRATED ASHPAN



The Redbank is a radiant and convection heater. The built-in ash pan ensures that disposal of ash is easy and convenient.

- Heats small to medium sized areas
- Flat radiant top allows for cooking
- Optional 2-speed fan for convection heating
- Lined with masonry fire bricks and a steel baffle for efficient burning
- 6mm top plate and baffle for durability
- Built-in ash pan to collect ash and make disposal easier

MODEL	993930
FINISH	VHT Black
FIREBOX	Steel
EST. PEAK OUTPUT	15kW
APPROX. HEAT AREA	150m ²
EMISSIONS	1.1g/kg
EFFICIENCY	62%
DIMENSIONS (WxDxH)	600 x 500 x 658mm
FIREBOX DIMENSIONS (WxDxH)	372 x 316 x 284mm
LOG SIZE	320mm

Minimum distance to heat sensitive materials (mm) when a flue deflector is fitted, and floor protector sizes as per standard AS/NZS 2918:2001.

FLUE SHIELD	A	B	C	D	E	F	G	H
FUF	200	225	300	111	150	427	525	477
	I	J	K	L	M	N	R	W
	522	822	975	1222	1048	548	674	600

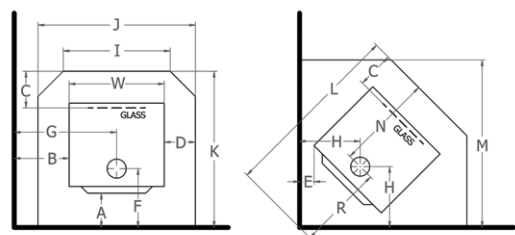

FUF: Flomet Universal Flue system with full length decorative heat shield.

