

Steel Freestanding Wood Fire (with wood stacker)



ROYSTON

Preceding model R1500WS



A practical storage solution teamed with heat, efficiency and style

- NES and ECAN clean air approved
- Heats small to medium sized areas
- 6mm flat radiant cook top and 6mm steel firebox for durability
- Easy installation with ash only floor protection required
- Handy storage space for wood

MODEL	993941
FINISH	VHT Black
FIREBOX	Steel
EST. PEAK OUTPUT	15kW
APPROX. HEAT AREA	150m ²
EMISSIONS	1.1g/kg
EFFICIENCY	62%
DIMENSIONS (WxDxH)	600 x 500 x 743mm
FIREBOX DIMENSIONS (WxDxH)	372 x 316 x 284mm
LOG SIZE	320mm



Minimum distance to heat sensitive materials (mm) when a flue deflector is fitted, and floor protector sizes as per standard AS/NZS 2918:2001.

FLUE SHIELD	A	B	C	D	E	F	G	H
FUF	200	225	300	111	150	427	525	477
AGA	100	325	300	111	175	327	625	467
	I	J	K	L	M	N	R	W
FUF	522	822	975	1222	1048	548	674	600
AGA	522	822	875	1257	1073	548	709	600

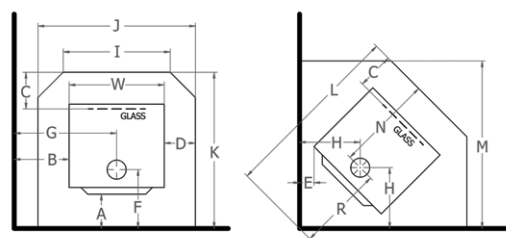

FUF: Flomet Universal Flue system with full length decorative heat shield.

AGA: Acom/Air Group Special Insulated Flue System

