

RYLSTONE

Preceding model Atlanta



Efficient and practical solution to warm up large spacious areas.

- Heats medium to large sized areas
- Efficiently heats areas up to 230m²
- 6mm steel firebox for durability
- Removable top grill for cooking
- Lined with masonry fire bricks and a steel baffle for efficient burning
- 2-speed fan for faster heat circulation

MODEL	992923
FINISH	VHT Black
FIREBOX	Steel
LOUVRE/GRILL	Silver
EST. PEAK OUTPUT	23kW
APPROX. HEAT AREA	230m ²
EMISSIONS	1.7g/kg
EFFICIENCY	59%
CIRCULATION	2-speed convection fan
DIMENSIONS (WxDxH)	640 x 595 x 754mm
FIREBOX DIMENSIONS (WxDxH)	450 x 517 x 267mm
LOG SIZE	400mm

Minimum distance to heat sensitive materials (mm) when a flue deflector is fitted, and floor protector sizes as per standard AS/NZS 2918:2001.

FLUE SHIELD	A	B	C	D	E	F	G	H
FUF	200	250	300	130	80	334	570	401
FUL	150	300	300	130	100	284	620	421
	I	J	K	L	M	N	R	W
FUF	600	900	1102	1335	1156	768	567	640
FUL	600	900	1052	1363	1176	768	595	640

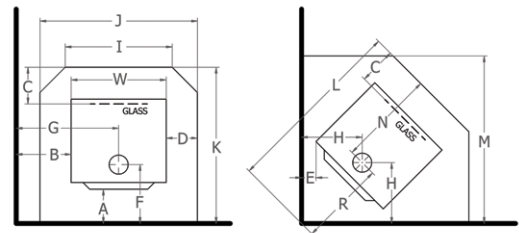

FUF: Flomet Universal Flue system with full length decorative heat shield.

FUL: Flomet Universal Flue system with Masport double flue shield. For detailed specifications please refer to installation manual.

