



30⁺

**HOURS
BURN TIME**

Regency Richmond Extra Large Hybrid Catalytic Wood Stove

Regency Richmond & Kingston

Extra Large & Large Hybrid Catalytic Wood Stoves
Featuring Eco-Boost Technology

You don't have to sacrifice *style* anymore.

The Regency Richmond and Kingston Wood Stoves let you enjoy the impressive heat performance of Regency's largest classic wood stoves with today's clean modern styling. These catalytic wood stoves deliver both function and style that features sleek lines, a contemporary door design and large clean viewing area of a roaring wood fire.

A broad heating *range* means flexibility.

The loading capacity combined with the controllable burn rate of our Eco-Boost technology provides flexibility to heat smaller homes with less reloading and large homes with the maximum capacity available.

Regency Kingston Large Hybrid Catalytic Wood Stove

24⁺ HOURS
BURN TIME



Hybrid Catalytic Technology

The catalytic combustor permits the wood stove to burn slowly delivering 24 hours of heat or more* with a single load of wood. Fuel is utilized to its full potential with minimal emissions and high efficiency!



Burn All Day & All Night

Regency Hybrid Catalytic Wood Stoves have the largest fireboxes available! Load up to 40kg of wood (Richmond) at a time for hours of consistent, reliable heat. Convenient loading of logs north to south and east to west.



Easy Single-Lever Operation

A simple single-lever air control conveniently located can be adjusted to meet home heat requirements, from a hot burn to a smoldering glow that keeps the chill away.



Large View Cast Iron Door

A heavy duty cast iron door offers a large viewing area delivering an excellent view of the roaring fire. The door opens to 170° making wood loading easy!

15 Year Limited Warranty

With over 30 years of wood stove manufacturing expertise, along with the most comprehensive warranty in the industry, Regency Catalytic Wood Stoves are guaranteed to deliver dependable heat. Consult the manual for complete details.



Standard Features

- Catalytic Stove with Eco-Boost Technology
- Single lever bypass control to engage catalyst
- Single-lever air control to adjust heat output
- Brick-lined firebox
- Rear heat deflector
- Airwash system helps keep the glass clean
- Discreet ashlip
- Contemporary cast iron door in black with large viewing area
- 170 degree opening door for easy loading
- Thermometer

Optional Features

- Extra large ash drawer with cover
- Two-speed fan
- Convector airmate

Custom designed Eco-Boost technology (developed in 2012)	Richmond (Extra Large)	Kingston (Large)
Heating capacity	over 250m ² **	over 230m ² **
Firebox capacity	0.125m ³	0.08m ³
Maximum wood load	40kg	27kg
Log size (front-to-back)	559mm	508mm
Log size (side to side)	559mm	508mm
Emissions	1.4g/kg	1.0g/kg
Weight	235kg	188kg
Efficiency	72.9%	84.3%
Door	635mm W x 406mm H 17kg heavy cast iron	552mm W x 378mm H 12kg heavy cast iron
Viewing area	1161cm ²	1157cm ²
Loading opening	511mm W x 254mm H	435mm W x 203mm H
Fan (optional)	2 SPD (automatic operation)	2 SPD (automatic operation)
Bypass assembly	heavy cast iron	heavy cast iron
Air control	single lever, easy front access	single lever, easy front access
Firebox construction	heavy duty 5mm steel	heavy duty 5mm steel
Ash pan (optional) capacity	511cm ²	511cm ²
Positive cam latching system	yes	yes

* Length of burn time and KW output depend upon wood species used, moisture content of wood, elevation, climate conditions and installation.

** Varies depending on home floor plan, house layout, heat loss of the house and quality/moisture content of wood.

Eco-Boost Technology

Secondary Air Tube

The secondary air tube, working with the catalyst, ensures the fuel is burned to its full potential resulting in low emissions and high heat output.

Catalytic Combustor

Helps create consistent heat by slowly burning unused fuel that would normally go up the chimney as smoke.

Convactor Airmate

Optional airmate to help direct warm air further into the room.

Heavy Duty Stainless Steel Flame Shield

Provides better distribution of gases over the catalyst and protects the catalyst from direct flame exposure.

Simple Temperature Thermometer

The easy to read thermometer indicates when to close the bypass lever and engage catalytic activity.

Air wash System

Helps keep the glass clean and provides an excellent view of the roaring fire.

Cast Iron Bypass Damper

Is used to close the damper and engage the catalytic combustor.

Single Lever Air Control

Easily controls the heat output and size of the fire by adjusting the amount of air intake.

Fan

The 2-speed fan quickly distributes heat throughout the room.

Extra Large Optional Ash Drawer

The largest concealed ash drawer that allows for easy clean up.

Room Air

Air from the room is drawn in through the bottom of the stove for the primary and secondary combustion.

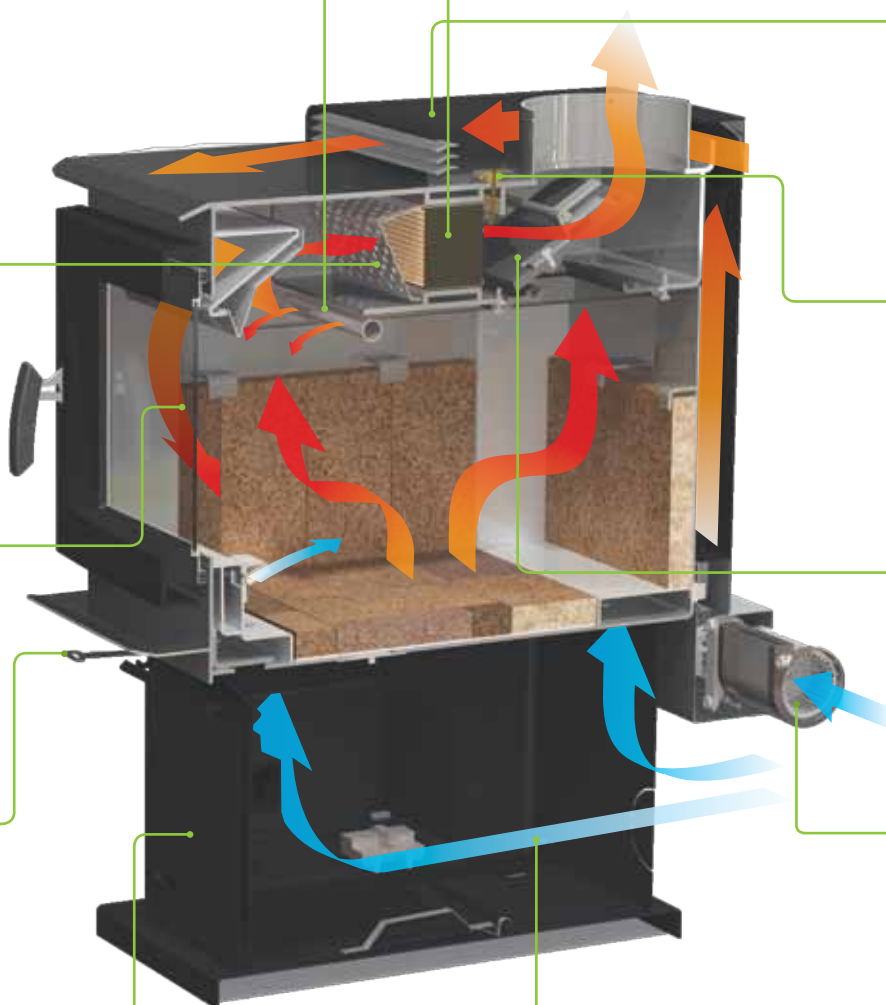

How does Eco-Boost *work*?

A heavy duty, secondary air tube is strategically placed to ensure maximized re-burn of products of combustion before making their way to the combustor. Serving as a pre-filter, the Eco-Boost system maximizes efficiency and prolongs the life of the catalytic combustor by decreasing its exposure to harmful combustion substances.



Specifications

Dimensions

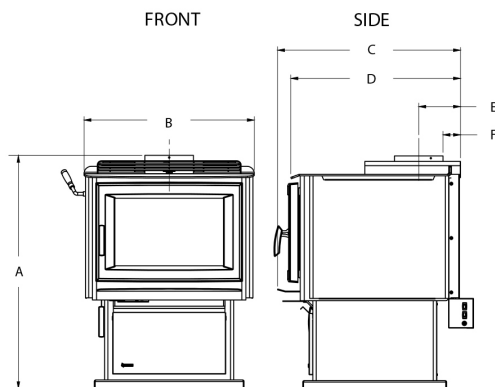

	A	B	C	D	E	F
Richmond	1010mm	737mm	792mm	735mm	181mm	76mm
Kingston	914mm	660mm	710mm	651mm	225mm	86mm

Floor Protection

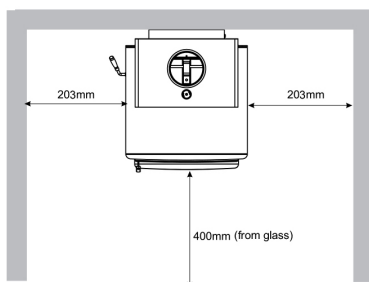

Minimum Clearances to Combustible Materials

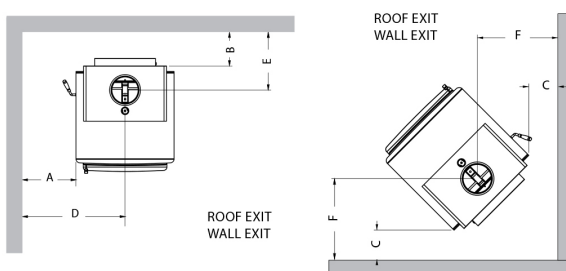

Residential clearance with an approved triple skin flue vent	FROM UNIT		FROM CORNER		FROM FLUE CENTER-LINE		MIN. WIDTH & DEPTH OF ALCOVE	
	A	B	C	D	E	F	G	H
Richmond with Airmate or Rear Deflector	305mm	203mm	100mm	674mm	381mm	469mm	1600mm	1219mm
Kingston with Airmate or Rear Deflector	250mm	150mm	100mm	580mm	317mm	419mm	1524mm	1219mm

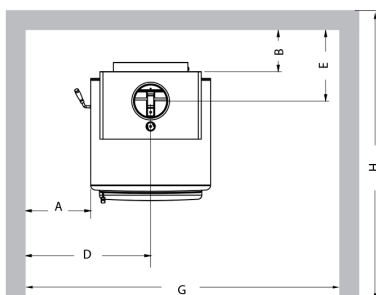

Minimum Alcove Clearance to Combustible Materials

The Regency Freestanding models have been alcove approved and must be installed with an approved triple skin flue vent.

Note: Minimum alcove ceiling height - 2108mm Vertical Termination

for your nearest dealer:

www.regency-fire.com.au

or call 1 800 081978

Fireplace Products Australia Pty Ltd.

1 Conquest Way,
Hallam VIC 3803
Australia
Phone 1 800 081 978
Fax 03 979 97822
Email: sales@regency-fire.com.au

Distributor WA
Air Group Australia
28 Division St.
Welshpool WA 6106
Australia
Phone 08 9350 2200

These are guidelines only, subject to change without notice. Always refer to the actual product manual that comes with your unit for specific, current dimensions and clearances.

© 2014 FPI Fireplace Products International Ltd. Regency is a registered or proprietary trademarks of FPI Fireplace Products International Ltd. All rights reserved. (03/14) Part no. 944-420

your Regency dealer

- SPECIALIST REGENCY DEALER -

HEATWORKS
COOLWORKS

126 MAGILL RD NORWOOD // 608 NORTH EAST ROAD HOLDEN HILL